

RESIDENTIAL PROPERTY RECORD CARD

Date Printed 06/25/14

Owner Information

Parcel **CE0091**
 Owner **STEECE, DAVID D & PAMELA P**

PO BOX 523
 RICHMOND, VT 05477

Location **91 CEMETERY RD**
 Descr: **DWEL**

Parcel Value Information

Land Value 67,500 Homestead 270,700
 Dwelling Value 188,200 Housesite 270,700
 Site Imprvmt 15,000
 Outbuildings 0
 Misc. Adj. 0
 Total 270,700

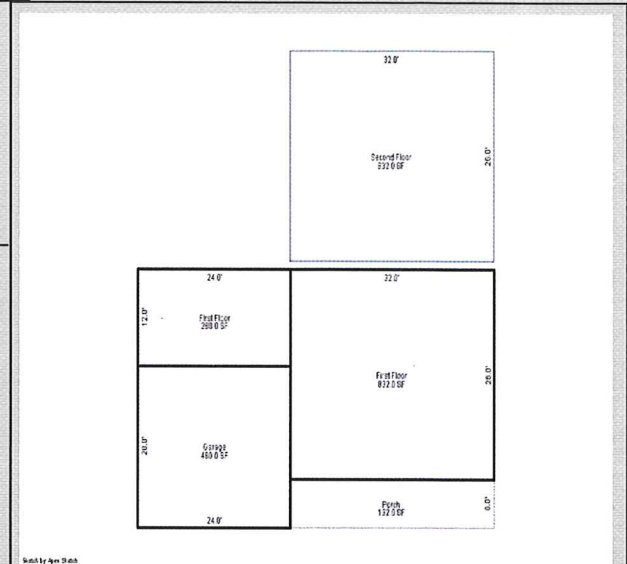

Sketch Updated: / /

Parcel Information

Tax Map # **CE0091** NBHD **9**
 Span **519-163-11470** Acres **1.60**
 Status **A - Active** Last Update **09/24/07**

Sales Information

Book Sale Date / /
 Page Sale Price 0

BUILDING	Total Rooms	8	Year Built	1973	Building SF	1952	Energy Adj	Average	Roughins	1
	Bedrooms	4	Effect Age	35	Quality	3.00	Bsmt Wall	Conc 8"	Plumb Fixt	7
	Full Baths	1	Condition	Average	Style	2 Story	Bsmt SF	832.00	Fireplaces	1
	Half Baths	1	Phys Depr	18	Design	Two Story	Bsmt Fin	UnFinsh	Porch	192
	Kitchens	1	Funct Depr	0	Bldg Type	Single	Bsmt Fin SF	0	Gar/Shed	480
			Econ Depr	0					% Complete:	0

LAND CALC Site LAND Bldg Lot AREA 1.60 GRADE 0.95

NOTES