

LEGEND

Existing stormwater point

- Pipe Cross (not connected)
- Catchbasin
- Dry Well
- Drop Inlet
- Grate/Curb Inlet
- Yard drain
- Junction Box

NOTES

Map created using ANR GIS mapping technology.

1: 2,845

July 18, 2023



145.0 0 72.00 145.0 Meters

utilities.

State
mediate

shall

street

Asphalt Curb
Paved Walk

MH#57

Porch

House

Utility Pole

TP14
(See Note 8)

House

Tilden Avenue

TP13

TP12

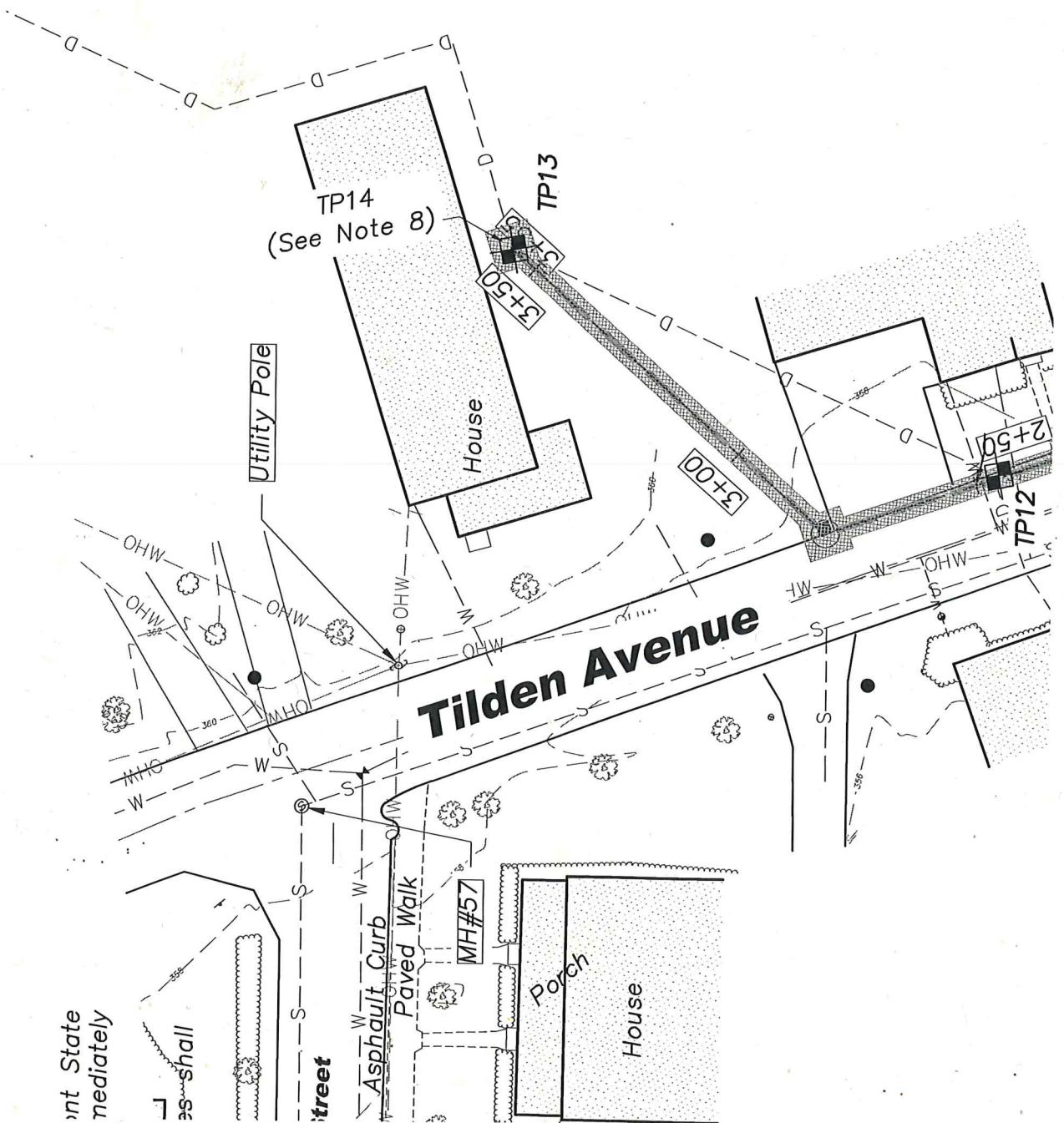

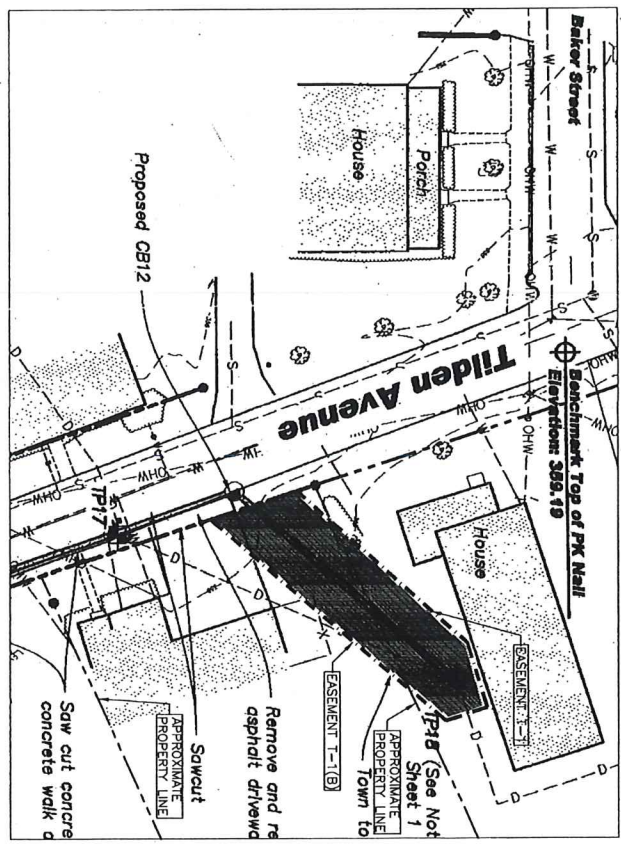

EASEMENT	PROPERTY OWNER
T-1	JOANNA BERK
T-1(B)	TAMMY PERRY

NOTE:
 THE PROPERTY LINES, EASEMENTS, AND OTHER PROPERTY DESCRIPTIONS PROVIDED IN THESE PLANS ARE FOR THE USE OF THE TOWN OF RICHMOND FOR THE CONSTRUCTION OF PUBLIC DRAINAGE. THE EXISTING EASEMENTS SHOWN ON THESE PLANS ARE NOT TO BE PERMANENTLY DERIVED BASED ON THE PIPE OR APPURTENANCE AS INSTALLED.

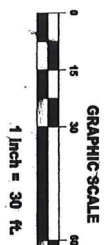

126

23388

RICHMOND, VT TOWN CLERK'S OFFICE
 RECEIVED FOR RECORD
 January 28 2010
 At 1 o'clock, P.M. and received
 Book 124 page 126 Map Records
 Attest: *Kimberly W. Poirier*
 Town Clerk

Stage	Applied	Approved
Concept Plan	<input checked="" type="checkbox"/>	<input checked="" type="checkbox"/>
Design Plan	<input checked="" type="checkbox"/>	<input checked="" type="checkbox"/>
Construction	<input type="checkbox"/>	<input type="checkbox"/>

GREEN MOUNTAIN ENGINEERING
 143 SOUTH BROWNELL ROAD
 WILTON, VT 05375
 TEL: (802) 536-3390
 FAX: (802) 536-7395



LLEWELLYN - HOWLEY INCORPORATED
 Consulting Services • Engineering • Permitting
 20 Kimball Ave Ste. 202N
 Vermont 05403
 T: (802) 658-2882
 F: (802) 658-2140
 http://www.lhinc.net

MILLET STREET & TILDEN AVENUE STORMWATER UPGRADE
 Contact: 44 Vermont
 Project: 18-002
 Date: 12/22/09
 Drawn by: TMO
 Checked by: TMO
 Sheet: 1 of 4