

# Periphery Setback Requirements for Jolina Court Zoning District

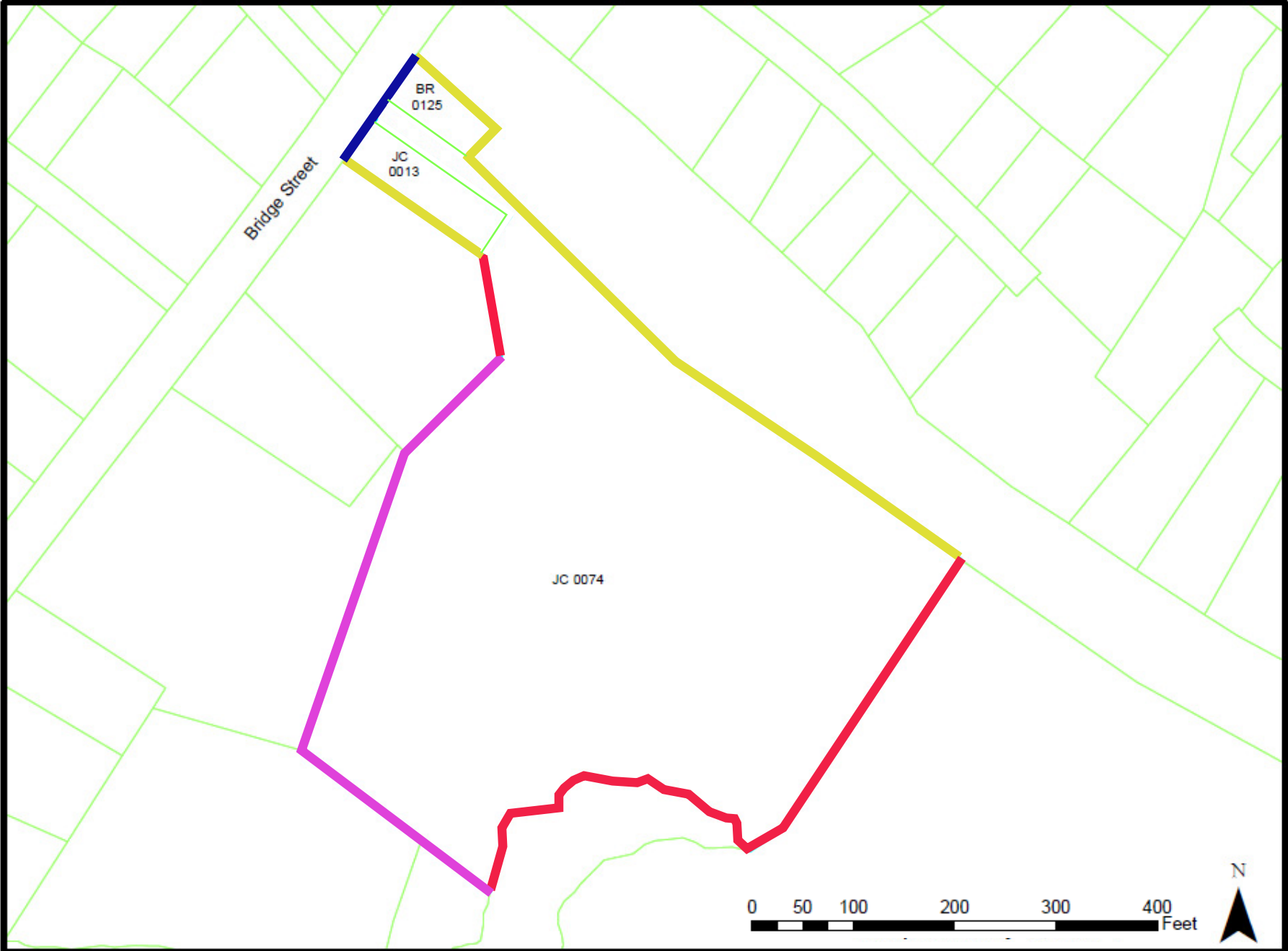

**Legend**

*Peripheral Lot Lines and Setback Requirements*

- 5 foot setback
- 10 foot setback
- 15 foot setback
- 20 foot setback

*Additional Information*

- Lot Lines not related to the periphery of the district

JC 0074 } Parcel ID  
JC 0013 }  
BR 0125 }

