

**Richmond Parking Advisory Committee (PAC) Meeting  
Monday February 13, 2023, 6:00 PM**

Richmond Town Center Meeting Room, 3<sup>rd</sup> Floor – 203 Bridge Street, Richmond, VT

Hybrid Meeting – In-person Meeting with Zoom Option

Attending: John Rankin, Diane Mariano, Chuck Gilroy, Kevin McAleer, John Cohn (remote)

Visitors: Chief Herrick, Fritz Martin, Lisa Miller, Bob Low, Jon Low, Teagan Low

6:01 PM Welcome & Public Comment

6:05 PM Discuss parking on Wes White Hill Road and at Gillett Pond

- John R asked Chief Herrick - any background on situation with Wes White parking
- Chief Herrick has not ticketed there, it was Officer Dengler. She was simply enforcing the policy. Chief Herrick, stated out of fairness, we need to use the same policy as with other areas such as, Cochran Rd and Dugway Rd.
- John – quoting Bob Lowe. “For 50 years people have parked there and not been ticketed. John asked if it was state or town ordinance.”
- Check Herrick says its town ordinance pertaining to “parking on traveled portion”. Town tickets are \$25, left on hood for user of the car. If State infraction, ticket goes to the owner. John asked could a warning be issued instead. Check Herrick said that warning is always an option.
- John R asks if Wes White could be given less priority.
- Bob Lowe points out that like he, folks have been parking there for at least 50 years with no problems. Now their first notice will be a ticket. Could this be a warning.
- Bob asks about parking in a pullout on right side which is off traveled portion. Chief Herrick said that would be ok. There’s no bar to parking in the right of way. Bob Lowe points out that the ordinance actually does explicitly not allow parking in the town right of way. (See State Statue Title 23, chapter 13, subchapter 10 Standing and parking). This may imply that parking in the town right of way may be illegal everywhere.
- Discussion on whether State Right of Way and Town Right of Way are the Same. If that John R suggests we check with Town Attorney to understand the language.
- Fritz showed the RLT signs currently posted on Dugway Road.

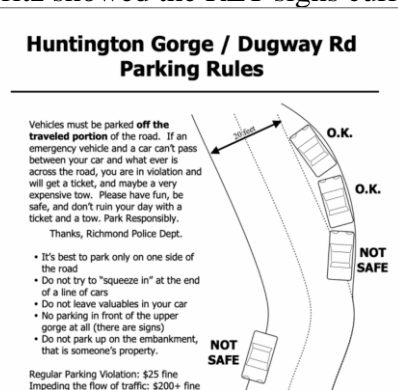

- Jon Low asked question. ‘Can we change ordinance to support common sense parking? rather than arguing over what existing ordinance says. He went on to say that Wes White has been widened several times in the past several years. He questions whether the ditches are even in the town right of way.
- Discussion about what is the legal width of the road. Fritz showed a map. We assume its 3 rods and need to check.
- Chief Herrick. Is it true when there are more than 6 cars, it means a hockey game. Several spoke up that there were often more than that. Bob Low counted more than 100 people on Presidents Day. He estimated there were probably 40 cars.
- Chief Herrick said there may be 40 cars parked safely, but then the 41<sup>st</sup> may do something stupid.
- Chuck G discussed a pull off near the “far” (Huntington) end of the pond.
- Discussion about who uses pond and for what. John Low pointed out usage isn’t the point. It’s where people choose to park.
- Fritz Martin shows map of proposed new parking. Discussed where 6 planned parking spaces will be. He pointed out drainage and site lines. Parking will be covered with gravel. Understand that even though 6 places are planned, more may pack in. The edge will be ditched which will prevent overflow parking. Plan is to have the parking finished by Fall. John C asked. where did the number 6 come from? Fritz answered it was due to the space available. Fritz has provided a doc which is appended to these notes.
- Active discussion around photographs and line of sight was discussed. Pros/cons of allowing parking on both sides of Wes White. General agreement that banning parking on one side would prevent most danger of blocking travel caused by cars on both sides. General agreement that ‘inside edge’ (pond side) of the road is better parking.
- Chief Herrick suggested that the town could spread 6’ of gravel for about 120’ on pond side of road. Question came up about impacting drainage provided by current dishes Diane M said that Pete could put a culvert there and cover it with gravel. It could be expensive.
- Jon Low suggested putting the parking across from the pond due to water concerns.
- Discussion about lines of site at the base of Wes White. Suggestion is that we get Pete and RPD there for a site visit to measure the site.
- Chuck suggests we should ask the Girl Scouts if they would consider opening or moving the gate. There’s a clearing near the entrance that would allow considerable additional parking.
- Next steps:
  - Priority is to understand how the State and Town ordinance relate for all roadside parking
  - Plan a site visit with Road Manager (Pete) and RPD
  - Chief Herrick to check with Ofc Dengler on how many tickets have been issued on Wes White

- Due to Selectboard by Wednesday this week. John R proposed language that shifted from explicit feet to landmarks.
- We had discussion on what the town and state ordinance was for parking ban from edge of town highway. Upon research the ordinance is 25 feet.
- We discussed the wording and simplified as follows

No person shall park any vehicle:

Along either side of TH#03 (Cochran Road) from the intersection with TH#5 (Duxbury Road) to the Edmunds Bridge (Huntington River Bridge) except where parking has been explicitly designated.

- We updated the map to reflect that language

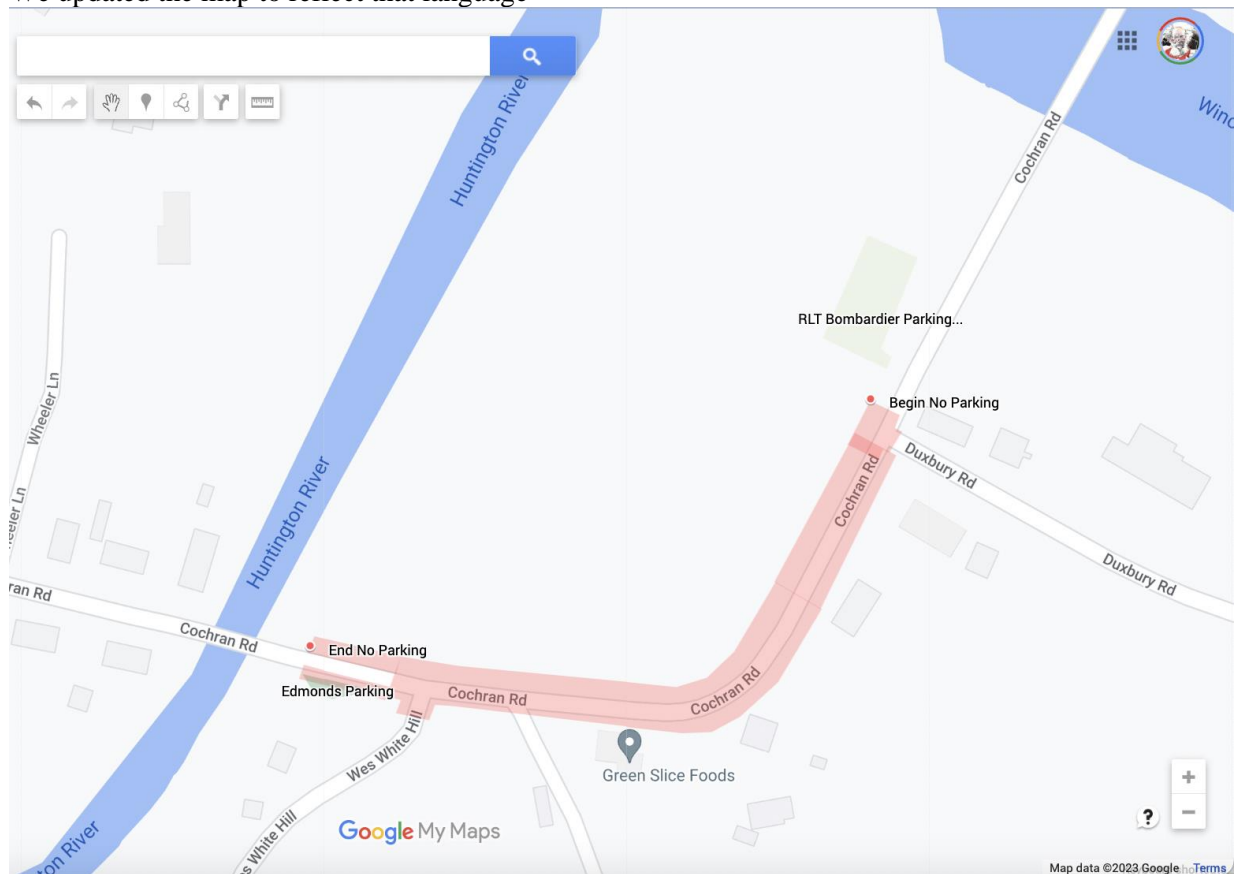

### 7:48 PM Enforcement

- Chief Herrick described reaching out to the Sheriff's department to see if they can assist in enforcement. They declined due to staffing.
- Discussed the possibility of paying the Town Constable for additional work but payment for some time would require payment all the time and the town is not able to do that,
- Discussed adding paid civilians. Chief Herrick pointed out that while most people who are being ticketed are well behaved, there is the possibility for confrontation. Discussed other complexities of hiring civilians to enforce town laws.
- Discussed complexity of paying existing constable role for additional parking enforcement. The complexity is there needs to be a clear line between which parts of

the role are being paid and which are not.

- Possible proposal to ask Selectboard to consider paying the Town Constable for his role and then agree how many hours could be devoted to parking enforcement.
- Discussed fine structure. Chief Herrick supports the PAC suggestion to raise parking fines round town to match the State average.

8:14 PM Communication (usage, feedback, calendar)

- Tabled due to time

8:15 PM Anything Else?

- Nothing

7:15 PM. Approve Past Meeting Minutes

- Passed by all

7:50 PM. Agenda for Next Meeting

- To be agreed by email

8:16 PM Adjourn

# Appendix: RLT Map of proposed Gillette Pond parking as provided by Fritz Martin

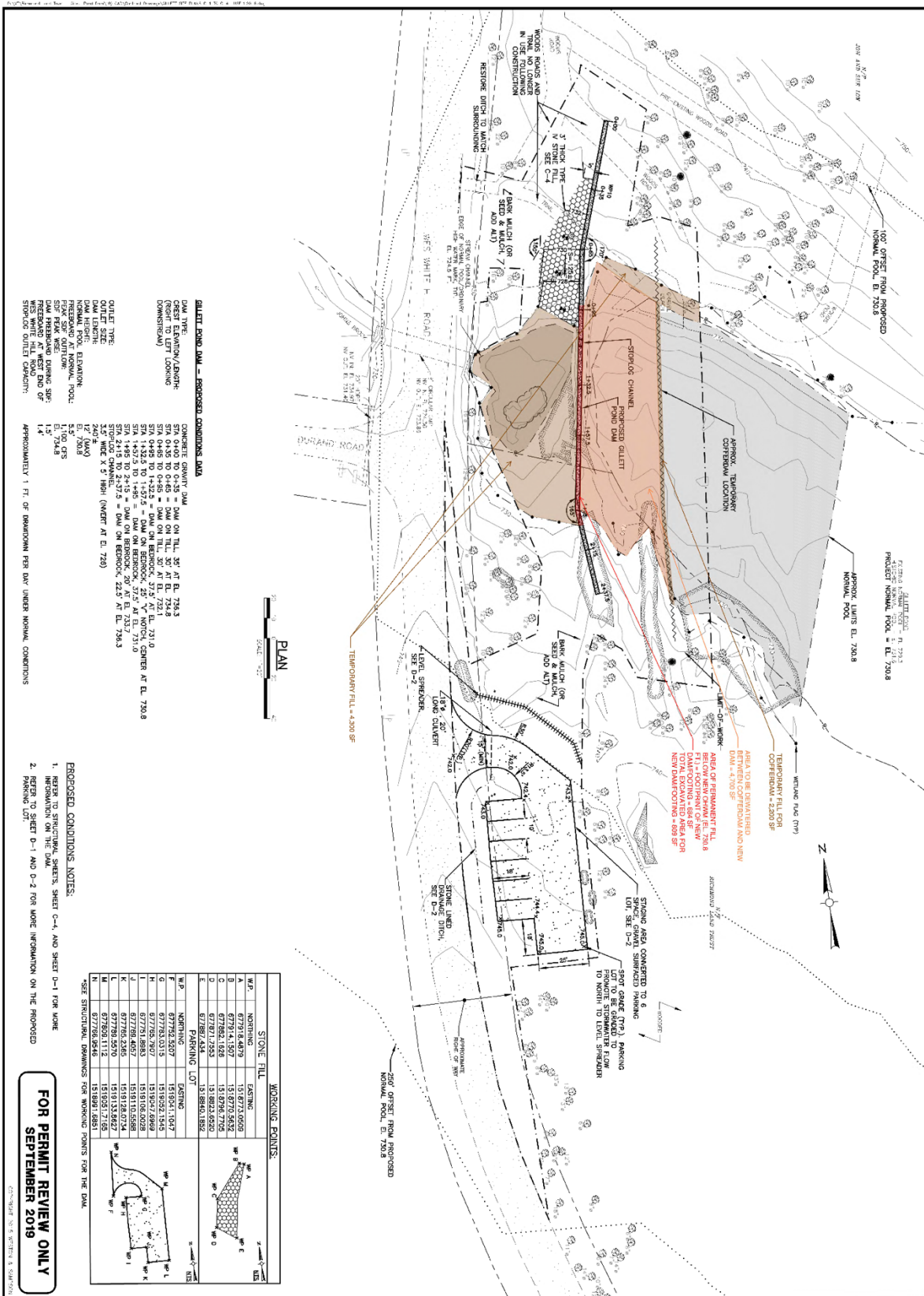

**GILLETTE POND DAM - PROPOSED CONDITIONS DATA**

**CONCRETE DAM DATA**

CHEST ELEVATION/LENGTH (RIGHT TO LEFT LOOKING DOWNSTREAM)

SN 0400 TO 0435 = DAM ON TILL, 35' AT EL. 724.3

SN 0435 TO 0445 = DAM ON TILL, 10' AT EL. 724.8

SN 0445 TO 0455 = DAM ON TILL, 10' AT EL. 724.8

SN 0455 TO 1432.5 = DAM ON BEDROCK, 27.5' AT EL. 721.0

SN 1432.5 TO 1457.5 = DAM ON BEDROCK, 25' V. NORTH, CENTER AT EL. 720.8

SN 1457.5 TO 2415 = DAM ON BEDROCK, 20' AT EL. 721.0

SN 2415 TO 2437.5 = DAM ON BEDROCK, 22.5' AT EL. 724.3

SN 2437.5 TO 2450 = DAM ON BEDROCK, 12.5' AT EL. 724.3

**OUTLET SIZE**

24' DIA

**DAM LENGTH**

120' (DAM)

**NORMAL POOL ELEVATION**

EL. 720.8

**PEAK SPILLWAY ELEVATION**

EL. 724.8

**SPILLWAY WIDTH**

14'

**RESERVOIR AT WEST END OF DAM**

1.4'

**STORAGE OUTLET CAPACITY**

APPROXIMATELY 1 FT. OF RAINFALL PER DAY UNDER NORMAL CONDITIONS

**WORKING POINTS**

POINT	EASTING	NORTHING
A	677791.84879	1518773.06659
B	677781.15077	1518770.54392
C	677780.19268	1518796.27005
D	677780.19268	1518770.54392
E	677782.4434	1518840.18827
F	677782.4434	1518840.18827
G	677782.4434	1518840.18827
H	677781.89883	1518106.20288
I	677781.89883	1518106.20288
J	677781.89883	1518106.20288
K	677781.89883	1518106.20288
L	677780.5570	1518133.84627
M	677780.1112	1518053.17165
N	677780.1112	1518053.17165

- PROPOSED CONDITIONS NOTES:**
- REFER TO STRUCTURAL SHEETS, SHEET C-4, AND SHEET D-1 FOR MORE INFORMATION ON THE DAM.
  - REFER TO SHEET D-1 AND D-2 FOR MORE INFORMATION ON THE PROPOSED PARKING LOT.

**FOR PERMIT REVIEW ONLY**

SEPTEMBER 2019

RICHMOND LAND TRUST  
TOWN OF RICHMOND, VERMONT  
GILLETTE POND DAM REPLACEMENT PROJECT  
PROPOSED CONDITIONS PLAN

DATE: 09/11/19  
SCALE: AS SHOWN  
DRAWN BY: BTG  
CHECKED BY: RWS  
DATE: 09/11/19  
SCALE: AS SHOWN  
DRAWN BY: BTG  
CHECKED BY: RWS

Weston & Sampson  
80 South Main Street, Waterbury, VT 05676  
(802) 244-0251  
www.westonandsampson.com