



ACCESS PERMIT APPLICATION

Permit # 2021-018
Parcel ID: GP 0760

Any new or modified access areas onto a Town highway requires Town approval. For access proposals on State roads, including RT 2 and RT 117, applicants are required to apply directly to VT Agency of Transportation. For local approvals, please review section 6.6 of the Public Improvement Standards & Specifications for the Town of Richmond (see municipal website) and provide all the information requested in this application. If you have questions please contact the Highway Department at 434-2631. Additional local permits and approvals may also be required, for information contact the Zoning Administrative Officer at 434-2430.

Application Date: _____ Physical Address of Property: 760 Gov. Peck Hwy
Applicant Name: DAVID Villeneuve Property Owner Name: Brenda J Villeneuve Fam Trust
Applicant Mailing Address: PO Box 360 Owner Mailing Address: PO Box 360
Underhill, VT 05489 Underhill, VT 05489
Phone: 802-324-7472 Phone: 802-324-7472
Email: bcoldinvt@hotmail.com Email: bcoldinvt@hotmail.com

Description of Project: Present Dr/Residential Is property in floodplain? No

The Highway Department will review the proposal to ensure adequate sight lines, culverts and drainage issues. All new driveway culverts must have a minimum diameter of 15". Appropriate techniques such as headwalls and wingwalls may be required especially where erosion or undermining may be expected to occur. The landowner is responsible for purchasing and installing all required materials as approved for installation in the access permit. The landowner is responsible for all maintenance and repair for one year from the date of completion. For the replacement of existing culverts, the Highway Department will make the decision that an existing culvert has failed. The landowner will pay for the purchase price of the culvert. If the grade of the driveway is altered by the landowner so that the culvert is affected by frost action, the landowner will be responsible for repairs.

- Please include a Sketch Plan showing the proposed location of the new or modified access. (see reverse)
- Town Highway Access Application Fee—\$115 residential/ \$145 commercial

Submit the completed application form with the required fee to Planning & Zoning Office.

Signatures: The undersigned hereby certifies this information to be complete and true. BRENDA Villeneuve
David Villeneuve 8/31/21 David Villane 8/31/21
Applicant Signature date Property Owner Signature date

— DO NOT WRITE BELOW THIS LINE—OFFICE USE ONLY—DO NOT WRITE BELOW THIS LINE—OFFICE USE ONLY—DO NOT WRITE BELOW THIS LINE—OFFICE USE ONLY—

Application received by ZAO & forwarded to Highway Department (date & initial): 9/13/21 KO Fee: \$115

Application received & reviewed by Highway Department (date): 9-15-21 Decision: APPROVED / DENIED / WITHDRAWN

Comments: SIGHT LINE FROM ACCESS LOOKING NORTHEAST IS 400' Additional comments on reverse

Highway Foreman Signature: [Signature] Date: 9-17-21

Application received by Town Manager and scheduled for Selectboard approval (date of SB meeting): _____

Selectboard Decision: APPROVED / DENIED / WITHDRAWN Comments: _____

Selectboard Chair Signature: _____ Date: _____

Return approved application to Planning & Zoning Office for applicant notification and filing (ZAO date & initial): _____

TOWN CLERK'S OFFICE Received for Record: _____ A.D. _____ At _____ o'clock _____ minutes _____ M
And Recorded in Book: _____ page _____ Attest: _____

Sketch Plan: Please include a Sketch Plan showing the proposed location of the new or modified access, with accurate measurements from the centerline of the proposed access (where it meet the town road) to any permanent mark. Please follow the specifications and profiles from the current Public Improvement Standards & Specifications for the Town of Richmond, including the culvert size (diameter and length). Additional information may be required depending on the nature of the project.

Sketch Plan:

GP 0760, A

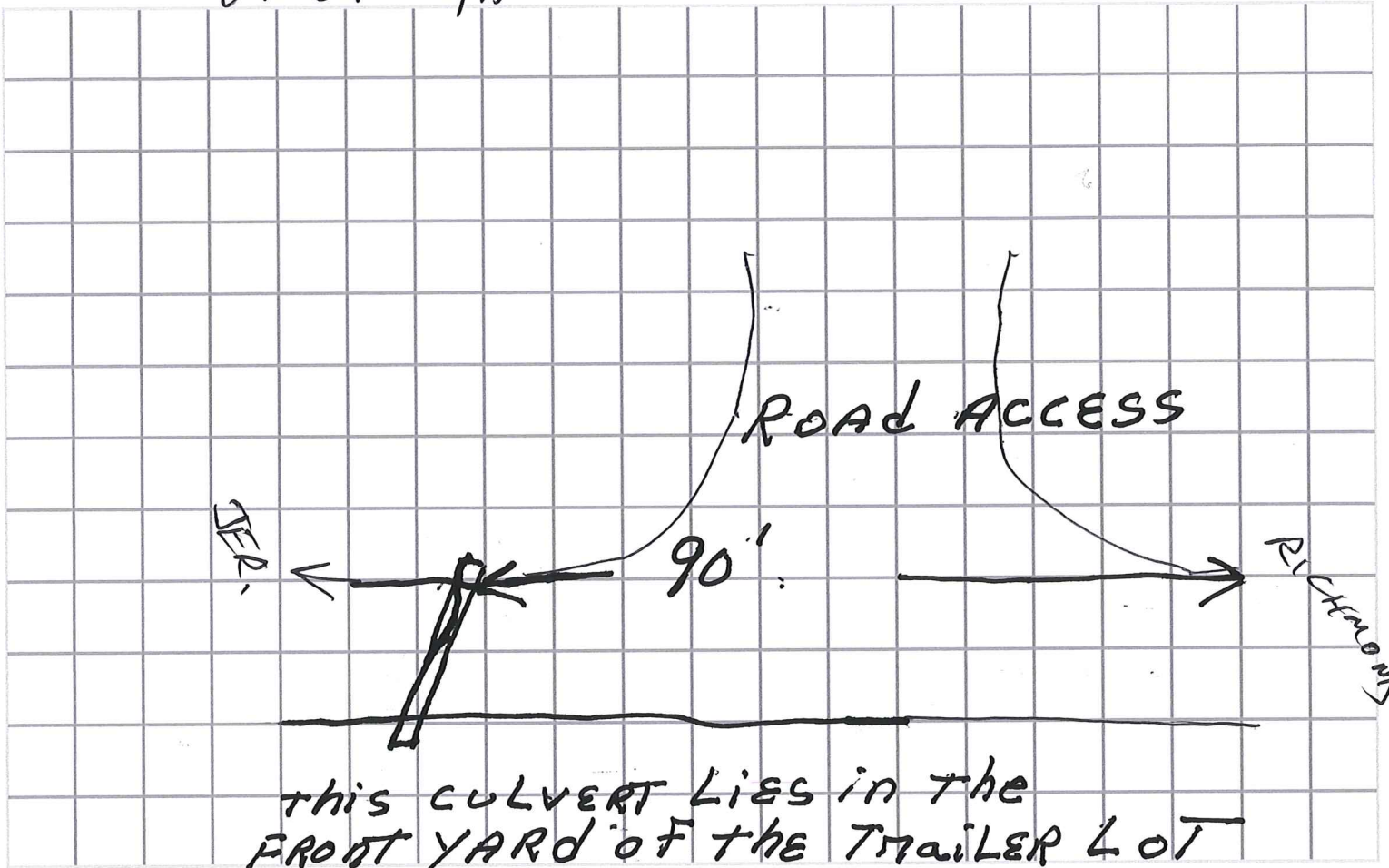

— DO NOT WRITE BELOW THIS LINE—OFFICE USE ONLY—DO NOT WRITE BELOW THIS LINE—OFFICE USE ONLY—DO NOT WRITE BELOW THIS LINE—OFFICE USE ONLY—

Highway Department Comments: SIGHTLINE FROM ACCESS LOOKING SOUTHWEST IS 600'. SIGHT DISTANCE IS ADEQUATE FOR ACCESS. ANR PERMIT REQUIRED TO CROSS THE BROWN CRITO PARCEL. APPLICANT RESPONSIBLE FOR ANR PERMIT.

Is a post construction inspection required? YES NO Reason for post construction inspection: _____

Fee required (insert amount): \$5 R.O. Fee collected (include amount and date received): _____

Is an independent professional inspection required? YES / NO Reason for independent professional inspection: _____

Fee required (insert amount): _____ Fee collected (include amount and date received): _____

Highway Foreman Signature: [Signature] Date: 9-17-21

Date of completed post construction inspection / independent professional inspection: _____

**AUTHORIZATION TO CONDUCT
STREAM ALTERATION ACTIVITIES**

Pursuant to Section C.2.2, and C.2.3
of the VT Stream Alteration General Permit

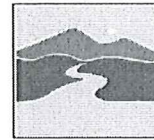

VERMONT DEPARTMENT OF
ENVIRONMENTAL CONSERVATION
**WATERSHED
MANAGEMENT DIVISION**
RIVERS PROGRAM

(Reporting activities requiring Application or Registration)

A. Permitted Project Information:

Project Number: SA-2830

Phone: 802-324-7472

Applicant Name: David Villeneuve

Email: bcoldinvt@hotmail.com

Mailing Address: POB 360, Underhill, VT 05489

Project Location: Tributary, Richmond, Gov. Peck Road, 44.239240⁰N, -72.557900⁰W

B. Findings:

The Secretary of the Vermont Agency of Natural Resources (VT ANR) has determined that:

This project consisting of installing a new 12' wide clear span bridge (minimum).

1. The proposed activity is eligible for coverage under the VT ANR Stream Alteration General Permit.
2. The proposed activity will meet the terms and conditions of the General Permit provided:
 - a) There is no work in flowing water associated with this project.

C. Standard Conditions:

1. The project will not adversely affect the public safety by increasing flood hazards.
2. The project will not significantly damage fish life or wildlife.
3. The project will not significantly damage the rights of riparian owners.
4. The project will not obstruct the movement of aquatic life indigenous to the waterbody beyond the actual duration of construction.
5. The project is conducted in a manner which minimizes or avoids any discharge of sediment or other pollutants to surface waters in violation of the VT Water Quality Standards.
6. The ANR River Management Engineer is notified by phone or email when construction begins and when the project is complete.
7. **In-stream working dates for all GP activities are from June 1st through October 1st; any in-stream work outside these dates will require consultation with and prior authorization from the River Management Engineer (RME).**
8. **This permit will expire: 10/01/2022.**

If there are any changes in the project plan or deviation in construction from the plan, the Permittee must notify the River Management Engineer immediately. If the project is constructed as you have described, as shown on the above referenced approved plans and per the above conditions, there is no reason to expect any violation of Vermont Water Quality Standards. Please be aware that the proposed project is in a municipality that participates in the National Flood Insurance Program (NFIP). Construction or storage within the Special Flood Hazard Area (SFHA) as delineated on the FEMA Flood Insurance Rate Map). 24 VSA, Section 4424 requires communities to submit SFHA permit applications to the ANR Regional Floodplain Manager for review and comment to ensure the project is compliant with local and NFIP minimum floodplain management standards. Please be aware that this authorization does not constitute ANR's review and comment under 24 VSA Section 4424.

D. Authorization:

Signed this 4th day of October, 2021
Peter Walke, Commissioner Department of Environmental Conservation

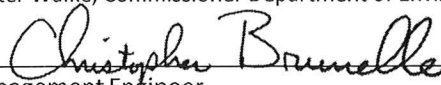
by:  River
Management Engineer
Rivers Program, Watershed Management Division

E. Engineer Contact Information

Engineer: Christopher G. Brunelle

Contact Phone: (802) 777-5328

Email Address: chris.brunelle@vermont.gov

9/29/20

GOV PECK RD 1/2 MILE FROM INTERSECTION / W 117
DAVE VILLENUEVE

DAVE, MINIMUM SPAN & HEIGHT REQUIREMENTS FOR BRIDGE

ARE AS FOLLOWS:

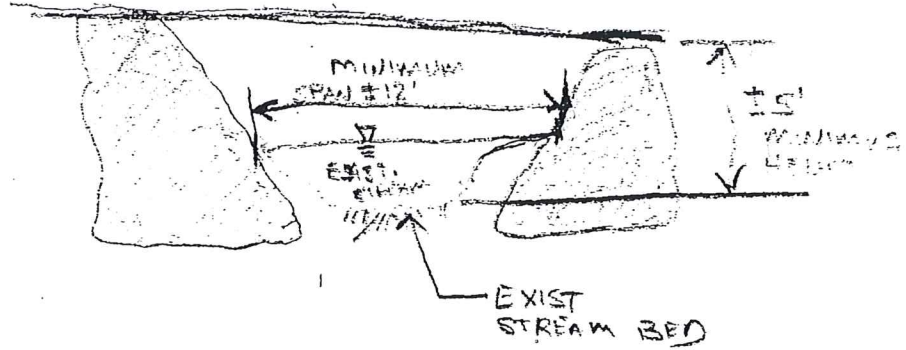

SINCERELY,

Chris Brunelle

CHRIS BRUNELLE, RIVER MANAGEMENT ENGINEER
777-5328

Chris.brunelle@vermont.gov

3

4

5

6

PAGE 3.1

PAGE 3

PAGE 3.1
PAGE 3

JERICHO

Governor Peck Hwy

GP0760,b

MW0437

MW0460

GP0760,a

GP0711

GP0643

GP0642

FL0068,a